



SUMMIT
AUTOMATION

Bringing Doors to Life!

Summit Automation provides
the world's best door and
window automation systems
with exceptional Customer care.



www.SummitAutomation.com



SUMMIT AUTOMATION

Bringing Doors to Life!

Summit Automation provides the world's best door and window automation systems with exceptional Customer care.



We invent, engineer, manufacture, and provide automation systems fit for those who want nothing but the best.

Industry Leader

- UL325 Certified System: 2+ years of testing our system for Safety and Reliability – Over 18K+ cycles tested
- Proven Performance: Over 13,000 installs
- Unmatched Reliability: State of the art electronics
- Comprehensive Warranty: Warranty on all parts beginning from date of final trim 1 or 3 year options
- Advanced Control Options: Wired and wireless wall switches and motion sensors, hand wave motion sensors, voice command capability, Bluetooth operation and wireless fobs (6-in-1 wall switch coming soon)
- SMART Control Box: Flexible programming options for Standard, FAST and FAST+ to customize door speeds
- When you call – We answer! Dedicated 24/7 support for Service, Sales and Engineering Associates ready to help

No other company can compare to the quality, reliability, and Customer care of Summit Automation.

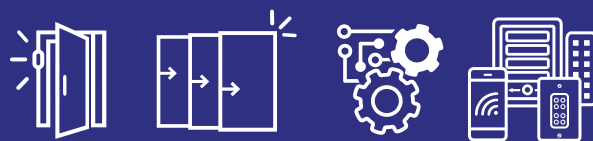

Whether you are building a smart home or looking to incorporate easy-to-use automation into your existing structure, Summit Automation has the right solutions for you. Our products:

- ✓ Add a touch of elegance and luxury
- ✓ Make opening and closing heavy windows and doors effortless
- ✓ Are easily operated with a push of a button or voice commands
- ✓ Provide added security
- ✓ Add convenience and fun to your life
- ✓ Are ETL Listed and UL325 Compliant

If It Moves – Automate It!

For more information call 480-500-5468 today!

MOTORS

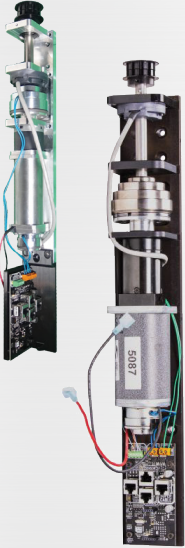

Tahoe

The Tahoe motor is our most recent release of our Base Series Motors operating a lighter door system. The Tahoe is very compact and fits within most jambs with a cover available.

Sierra

The Sierra motor moves up to 3 operable panels (depending on weight) and has a ultra slim profile.

Peak

The Peak is our flagship motor moving a majority of the systems we automate up to 8 panels depending on panel size and weight.

Everest

The Everest is capable of moving massive heavy door panels with an unlimited amount of panels. Before the Everest, any very long and heavy door system would require two motors as a bi-part, not anymore!

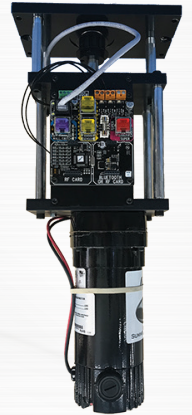

CONFIGURATIONS:



INVERTED



K2

Inverted or K2

When there is limited space behind either side of the door system (no stud bay or only a glass curtainwall), all of our motors can be mounted as Inverted (upside down) or as K2 (horizontally mounted with an aerospace-rated precision automated gear box). Both Inverted and K2 can hold an incredibly tight tolerance with numerous extension shafts allowing motors to be placed immediately above the door or up in the rafters without worrying about shaft flexing.

FMS

The FMS is our retrofit configuration motor suitable for all three motors (Sierra, Peak, & Everest) and is perfect for concrete or post-to-post construction. If there's no room for the motor the FMS bolts directly onto the back jamb and comes with a paintable cover.



Apex

The Apex is for corner-less 90-degree door systems or unequal bi-parting doors. Basically, the Apex configuration works with all of our motor (Sierra, Peak, & Everest) systems and couples two motors together with a communication cable between control boxes to coordinate the open and close operations. Our motors can be mixed & matched to move an unlimited number of panels per side on a 90 degree or unequal bi-parting system.

Pivot

The Pivot motor is our elegant solution automating pivot doors for both interior and exterior applications and can be mounted in two different locations: Above Header and Within Header. The pivot motor is a versatile solution for a controlled open and close regardless of wind conditions.



CONTROL OPTIONS

Flexible Adjustable Speed Technology (FAST/+)

Our much-anticipated latest software that allows all of our motor systems to enjoy a quick open feature thanks to our variable speed technology (VST) solution and allows for the motor to slow down as it picks up the next panel for a smooth but quick opening. In case you didn't know, all motors have the variable speed technology capability, however, it takes an expert to utilize this feature without causing harm to doors, homes, or persons. Summit is the UL 325 certified door automation system supplier in North America and is ETL Listed.

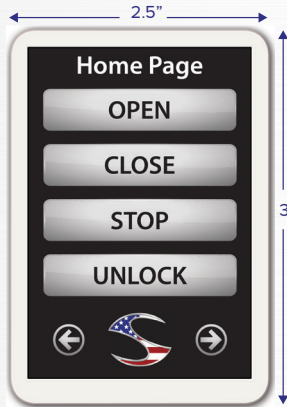

9-in-1 Touchscreen

- 2.5" wide by 3.5" high
- 90% LED Glass
- Timer Functions
- Auto Brightness
- Security Enabled
- Camo Mode (Hidden)
- Proximity Sensor
- Customizable Background

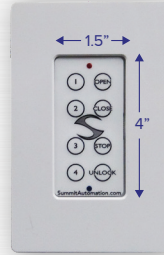

Wall Switch Kits

The wall switch kit comes standard with every system to open, close, stop, and unlock your doors, with only the push of a button. It can also enable and disable our self-close & auto-open as well as FAST/+ speed control features and may be 4 digit security code enabled. Wall switch kits are available in black or white and both wired and wireless options. We also just released our 6-in-1 wall switch option that provides timer functions for our features, as well as a proximity sensor for handsfree opening.

Summit Door Controller App

The Bluetooth Chip mounted on the motor accepts commands from our Summit Door Controller app (on Google Play and IOS App store) and can control multiple automation systems using your smartphone or tablet.



Voice Command Module (VCM)

The Voice Command Module (VCM) allows users to program and operate their automated doors by simply speaking to their Google Home, Alexa, ECHO, ECHO DOT devices while creating routines to enjoy your door systems to the fullest:

- Requires download of device APP (Google Home, Alexa)
- 1 VCM per motor
- Connects to the Home Automation Port on Summit Automation Control Box
- Programming instructions are provided, and programming assistance is available via Summit



Biometrics Fingerprint Access

Control access and functions using your fingerprint and you can authorize other users and administrators to do the same!

- Highly secure
- Unlocks & locks
- Opens & closes
- Up to 99 profile users
- Keeps track of who is present in the house or building
- Allows for time-restricted and limited-time authorization
- Can be integrated with other home automation controls
- Bluetooth enabled and can also be controlled via phone app



Exterior Tamperproof Keypad

The illuminated exterior keypad works great in any weather condition and is completely waterproof. Entering the proper code will send an open signal to the control box and give you access from the exterior of the door unit. Its slim 2" x 7" frame looks great on any exterior application.



Remote Fob Kits

The Remote FOB gives you ultimate convenience whether you're inside or outside. With a 75-foot range, the Remote FOB gives you total system control.

Wave Motion Sensor

Our Wave Motion Sensor is the perfect hands-free solution allowing you to open the door without even pressing a button. To operate your precision automated system simply wave your hand in front of the sensor and the door will automatically open with an adjustable sensitivity.



Head Track Motion Sensor (Wired/Wireless)

The Head Track Motion Sensor (T1) is an exterior motion sensor that is mounted center of the lead panel in track 2 with a customizable directional beam sensor cover. This sensor provides the end user the option of a hands-free entry, as well as a secondary safety feature.

Control Box

This is the brains behind every Summit Motor, and allows us to offer features like FAST/+ or quick open by utilizing our variable speed technology (VST). At merely 7.5" x 7.5" x 4.5", it gives installers flexibility to install within the pocket or up to 100 ft away from the motor in the data/AV/mechanical closet. The control box includes standard a lithium-ion battery back-up and plugs into a dedicated 15-amp standard 110v outlet while being compatible with all major home automation systems.

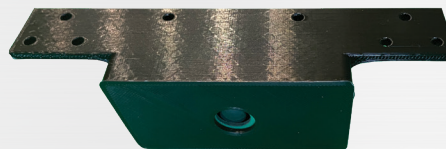
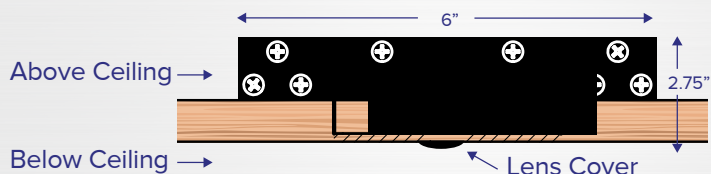

Hidden Flush Mount Motion Sensor (Wired/Wireless)

The Hidden Flush Mount Motion Sensor (H1) is an interior motion sensor that is flush mounted within the soffit with a customizable directional beam sensor cover. This sensor provides the end user the option of a hands-free entry, as well as a secondary safety feature.



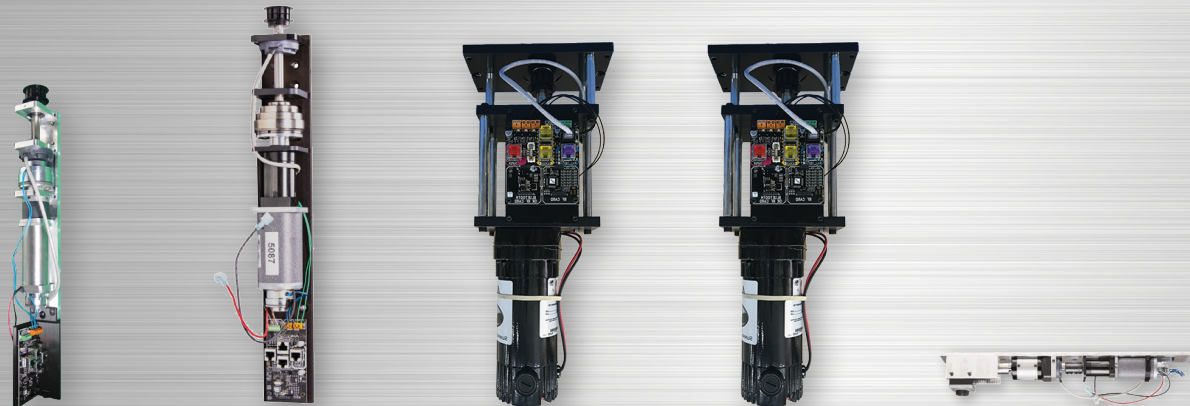

MOTORS	TAHOE	SIERRA	PEAK	EVEREST	PIVOT
USAGE	One Way or Bi-Part	One Way or Bi-Part	One Way or Bi-Part	One Way or Bi-Part	One Way or Bi-Part
Maximum Panels	1 to 2	2 to 3	3 to 8	Unlimited	Single & Multiple Panel
Maximum Combined Weight	400 lb	1000 lb	3000 lb	8000 lb	1400 lb
Motor Size	1.75" x 1.9" x 19"	2.75" x 2.9" x 22"	3.5" x 7.5" x 18"	3.5" x 7.5" x 18"	23" x 3.5" x 3.5"
Volts	24 DC	24 DC	24 DC	24 DC	24 DC
AMPS	4.5	4.5	4.5	4.5	4.5
MAG Brake	Yes	Yes	Yes	Yes	Yes
MAG Clutch	Yes	Yes	Yes	Yes	No
Encoder	Yes	Yes	Yes	Yes	Yes

CONFIGURATIONS					
FMS (With Cover)	Yes (Full or Face Only) Full – 1.9"x 2.1" x 15.12" Face Only – 1.75"x 2.1" x 15.12"	Yes (22" x 3.125" x 2.88")	Yes (23.5" x 4" x 5.88")	Yes (23.5" x 4" x 5.88")	No
K2 (Within I-Beam, Above Head Track, Wall/Ceiling Mount)	No	Yes (24" x 4.25" x 3")	Yes (23" x 5.75" x 3.5")	Yes (23" x 5.75" x 3.5")	No
Inverted (With Recommended Riser)	No	No	Yes (21.13" x 8" x 3.5")	Yes (21.13" x 8" x 3.5")	No
APEX (90 Deg Cornerless System)	No	Yes	Yes	Yes	No
Camelback	New Design Offering	New Design Offering	New Design Offering	New Design Offering	No
Within Jamb Shim Space	New Design Offering	New Design Offering	New Design Offering	New Design Offering	No